

FIRST FLOOR PLAN

ALL DIMENSIONS ARE SHOWN UNLESS OTHERWISE NOTED. DO NOT SCALE DRAWING. DIMENSIONS ARE SHOWN IN FEET AND INCHES.

SCALE: 1/8" = 1'-0"

SHOLE FAMILY - TWO STORY SQUARE FOOTAGE	
FIRST FLOOR	1,898 SQ. FT.
SECOND FLOOR	1,898 SQ. FT.
TOTAL	3,796 SQ. FT.
COVERED	442 SQ. FT.

NOTE 2: CEMENT/CONCRETE INSTALL AT PER PERMITS. INSTALLATION RESTRICTIONS.

NOTE 3: SMOKE DETECTOR ALL SMOKE DETECTORS TO BE LISTED AND WIRE-CONNECTED AND HAVE BATTERY BACKUP.

NOTE - SPLITTER VENTS
SPLIT VENT FROM GAS-FIRE PLACES SHALL BE INSTALLED TO THE EXTERIOR IN ACCORDANCE WITH THE MANUFACTURER'S INSTRUCTIONS. SPLIT VENTS SHALL BE CONSTRUCTED OF STEEL OR ALUMINUM. SPLIT VENTS SHALL BE INSTALLED WITH THE VENTER LAMEN OF A CLEARANCE FROM THE EXTERIOR SURFACE OF THE ROOF. SPLIT VENTS SHALL BE INSTALLED WITH THE VENTER LAMEN OF A CLEARANCE FROM THE EXTERIOR SURFACE OF THE ROOF. SPLIT VENTS SHALL BE INSTALLED WITH THE VENTER LAMEN OF A CLEARANCE FROM THE EXTERIOR SURFACE OF THE ROOF.

Drago Architects
Design & Planning Consultants
201 WARD STREET, SUITE 1
MORTONSBORO, IN 46169
848.457.578

BLDG.	MAIN LANE DEVELOPMENT
NO.	NO. 01
TEN. DESIGNATION	RESIDENTIAL
ZON. LOCATION	RESIDENTIAL
PREPARED BY	DRAGO ARCHITECTS
DATE	11/09/09
SCALE	AS SHOWN
DRAWN BY	DRAGO



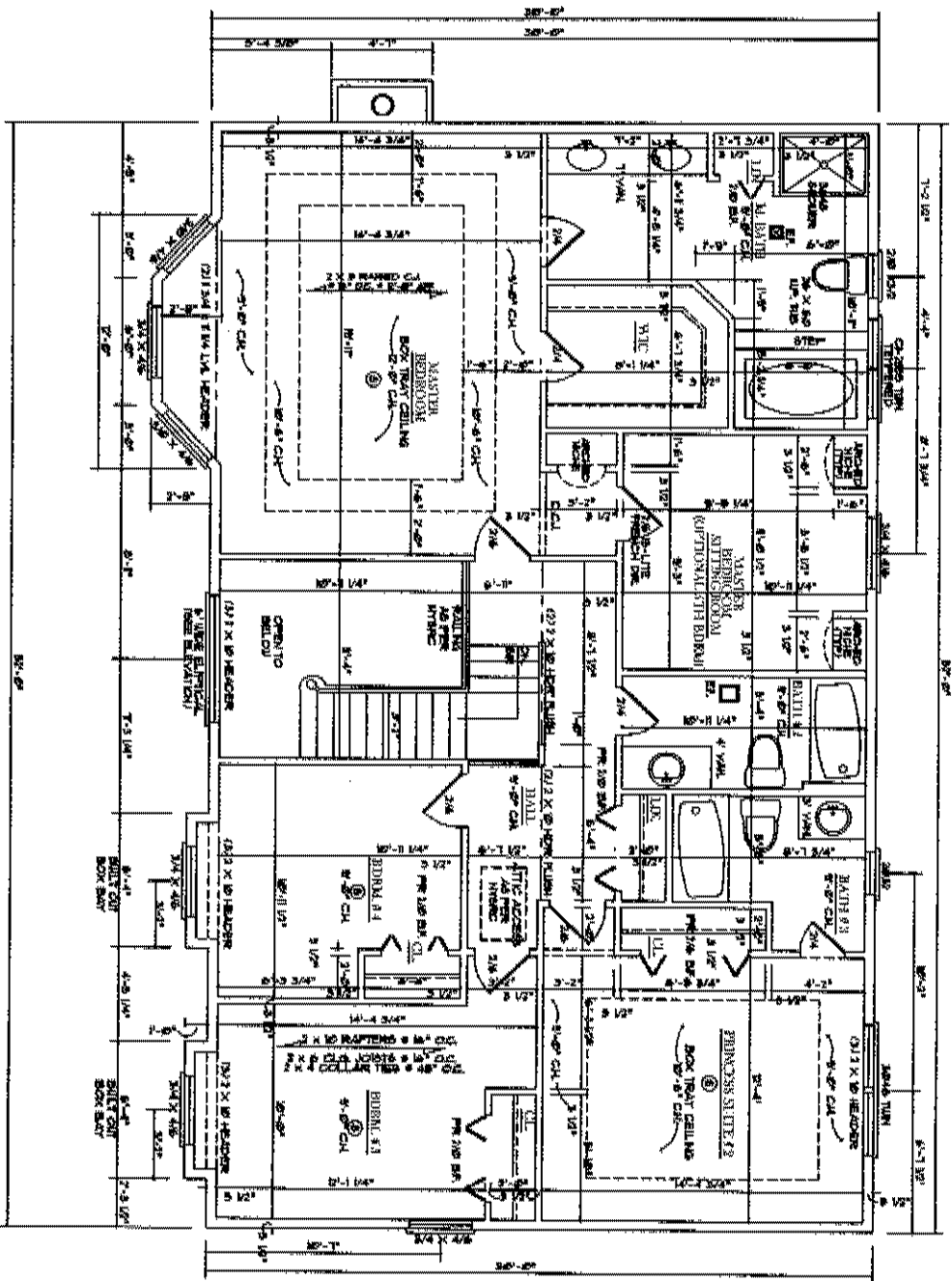

SECOND LEVEL FLOOR PLAN

ALL DIMENSIONS UNLESS OTHERWISE NOTED ARE IN FEET AND INCHES. DIMENSIONS ARE SHOWN UNLESS OTHERWISE NOTED. DIMENSIONS ARE SHOWN UNLESS OTHERWISE NOTED.

SCALE: 1/4" = 1'-0"

NOTE - BATHROOMS

ALL BATHROOMS MUST BE VENTILATED TO THE EXTERIOR. THE EXHAUST FAN SHALL BE INSTALLED IN THE EXTERIOR AND SHALL BE PROTECTED FROM WEATHER. THE EXHAUST FAN SHALL BE INSTALLED IN THE EXTERIOR AND SHALL BE PROTECTED FROM WEATHER. THE EXHAUST FAN SHALL BE INSTALLED IN THE EXTERIOR AND SHALL BE PROTECTED FROM WEATHER.

NOTE 1 - SMOKE DETECTOR

ALL SMOKE DETECTORS TO BE INSTALLED IN ACCORDANCE WITH THE MANUFACTURER'S INSTALLATION INSTRUCTIONS.

NOTE 2 - CARBON MONOXIDE

ALL CARBON MONOXIDE DETECTORS TO BE INSTALLED IN ACCORDANCE WITH THE MANUFACTURER'S INSTALLATION INSTRUCTIONS.

REVISION	DATE

EMERGENCY EGRESS NOTE:

1. ALL ROOMS SHALL BE PROVIDED WITH EGRESS DOORS AND PASSAGES THAT ARE UNLOCKED, UNOBSTRUCTED, AND MARKED AS EGRESS ROUTES. EGRESS DOORS SHALL BE INSTALLED WITH PUSH-BUTTON OPERATION AND SHALL BE KEPT CLEAR OF OBSTRUCTION AT ALL TIMES.
2. ALL SECOND FLOOR EGRESS DOORS SHALL HAVE AN EMERGENCY ESCAPE KIT WITH A MINIMUM OF 12 DOORS.
3. ALL EGRESS ROUTES SHALL BE MARKED WITH EGRESS ROUTE MARKINGS AT ALL TIMES AND SHALL BE KEPT CLEAR OF OBSTRUCTION AT ALL TIMES.
4. THE CONTRACTOR SHALL VERIFY THAT ALL ROOMS USED AS EGRESS ROUTES ARE UNLOCKED AT ALL TIMES.

EMERGENCY NOTE:

SEE IBC CODE COMPLIANCE REPORT FOR ALL ROOMS. SEE IBC CODE COMPLIANCE REPORT FOR ALL ROOMS. SEE IBC CODE COMPLIANCE REPORT FOR ALL ROOMS.

ALIGNED VENTILATOR NOTE:

THESE FANS ARE NOT VALID FOR A BLOW FAN. THESE FANS ARE NOT VALID FOR A BLOW FAN. THESE FANS ARE NOT VALID FOR A BLOW FAN.

Drago Architects
 Design & Planning
 Consultants

26 WARD STREET SUITE J
 MONROEVILLE, PA 15146
 412-835-5782

SHEETS	DATE
201	11/09/09
202	11/09/09
203	11/09/09
204	11/09/09
205	11/09/09
206	11/09/09
207	11/09/09
208	11/09/09
209	11/09/09
210	11/09/09



